

Swimming Pools – Building Permit Needed?

A Building Permit **is** required for the following types of swimming pools:

- In ground pools
- Above ground pools
(Including inflatable pools that hold more than 2 feet of water)

The following information is required for a Building Permit:

- Building Permit application
- Plot plan or survey of the property:
 - Show the improvements on the lot (house, deck, driveway, etc.)
 - Show where the swimming pool will be located with dimensions.
- A separate Building Permit is required for a fence, deck or buildings associated with the pool.

Basic Rules for Swimming Pools.....

1. The Pool must be at least 15 feet from all property lines.
2. A Safety Barrier is required to limit access to the pool.
3. Pools are not permitted in the front yard.
4. A separate Building Permit is required for a fence or deck.

City of Dover Planning and Inspections

15 Loockerman Plaza
Dover, DE 19901
(302) 736-7010
www.cityofdover.com

Swimming Pools

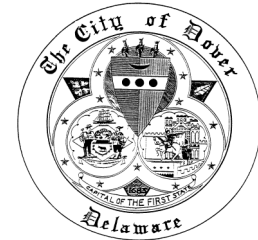

City of Dover Planning and Inspections

What are the Requirements for a Pool?

Safety Barrier

A Safety barrier **is required** for all pools. The barrier shall be a minimum of four (4) feet tall.

Above ground pools:

Barrier may be the edge of the pool if over four (4) feet and has a ladder that is removable or locks.

If the barrier is not the edge of the pool see the requirements for in ground pools.

In ground pools:

Barrier shall be a 4 foot fence. It shall include a gate.

The gate shall:

- Swing out from the pool:
- Be self closing with a self latching device.

Alarm

An alarm is required if the wall of the house is used as part of the barrier and a powered safety cover is not installed.

The alarm shall:

- Sound for 30 seconds;
- Start within 7 seconds of the door opening;
- Automatically reset;
- Provide a deactivation switch; with additional requirements.

Placement

The pool shall be fifteen (15) feet from the side and rear property lines. Buildings and pavement shall be five (5) feet from property lines.

No swimming pool is permitted to be located within the front yard between the house and the street.

Plot Plan Example

123 Main St

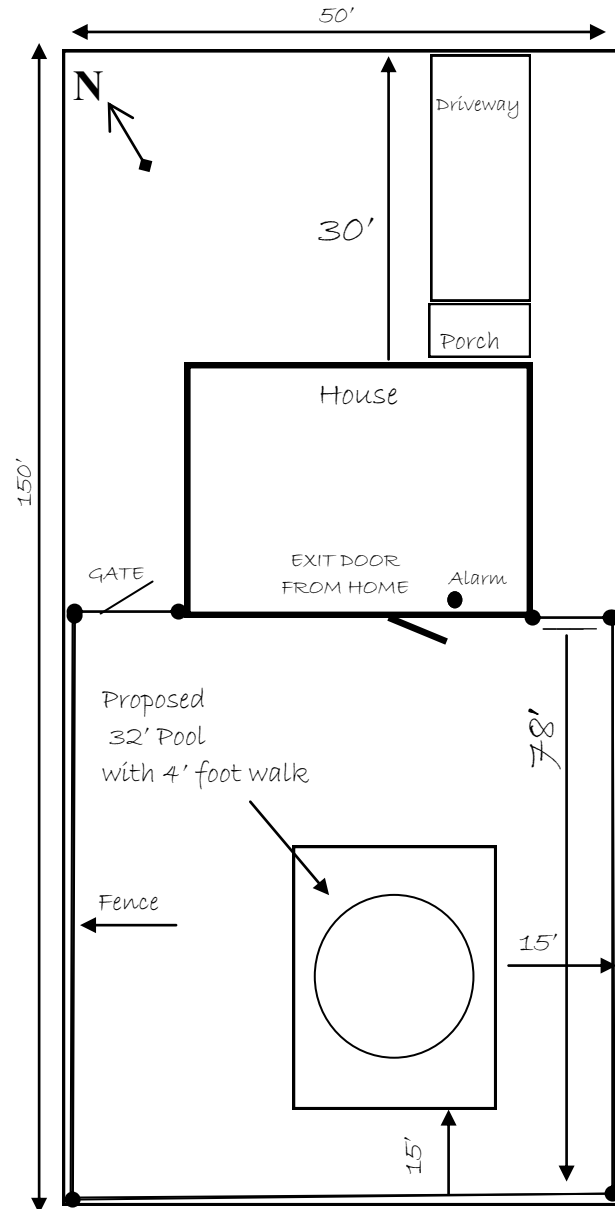

Pools—4-2012

Is an Electrical Inspection Required?

Electrical Work

An outlet is required for the motor/pump.

This will require work from a Professional Electrician.

The outlet shall be within 6-10 feet from the pool.

The use of an extension cord is **not** acceptable.

An electrical inspection is required for the installation of a new outlet. This shall be done prior to a Final Inspection.

An electrical inspection is not performed by the City. Electrical Inspections are a 3rd party inspection. Contact the Division of Professional Regulation for information at 302-744-4500.

Code References:

City of Dover Ordinances, Appendix B:
Zoning, Article 5

2009 ICC Building Code